

# YKK aP

www.ykkap.com

**ProTek**  
YKK AP Hurricane & Blast Solutions



Sea Star Scout Base - Galveston, TX

## YHC 300 IG

### Impact Resistant and Blast Mitigating Inside Glazed Curtain Wall System

The **YHC 300 IG** is an inside glazed, high performance curtain wall system designed and tested to meet the most demanding conditions. With varied infill and components, the YHC 300 IG can meet the requirements for Impact Resistance and Blast Mitigation. The system features a 3" wide face dimension to permit the glass engagement necessary for higher design pressures and accommodates 1/4" to 9/16" mono or 1" to 1-5/16" insulated glazing.

- Large and Small Missile
  - Small is Dry Glazed, Large is Wet Glazed
- ASTM E 1886 / 1996, TAS 201-203
  - Tested to +/- 120 psf\*
  - FL State-Wide & HVHZ Product Approval
- Blast Mitigation
  - Meets UFC 4-010-01 standard in accordance with 2007 revisions
  - With 35H Door - "Low Hazard" per ASTM F 1642 test @ 6 psi / 41 psi-ms

\*Contact YKK AP Engineering for a Wind Load Analysis at higher levels.

#### Configuration:

Glazing	Glass Setting	Installation
Inside	Front Set	Shear Block

#### Thermal Values:

<b>U-Factor:</b>	Values as low as <b>0.39</b> **
<b>CRF:</b>	Minimum <b>63</b> frame and <b>67</b> glass

\*\*Based on AAMA 507. Lower values may be achieved through further simulation.

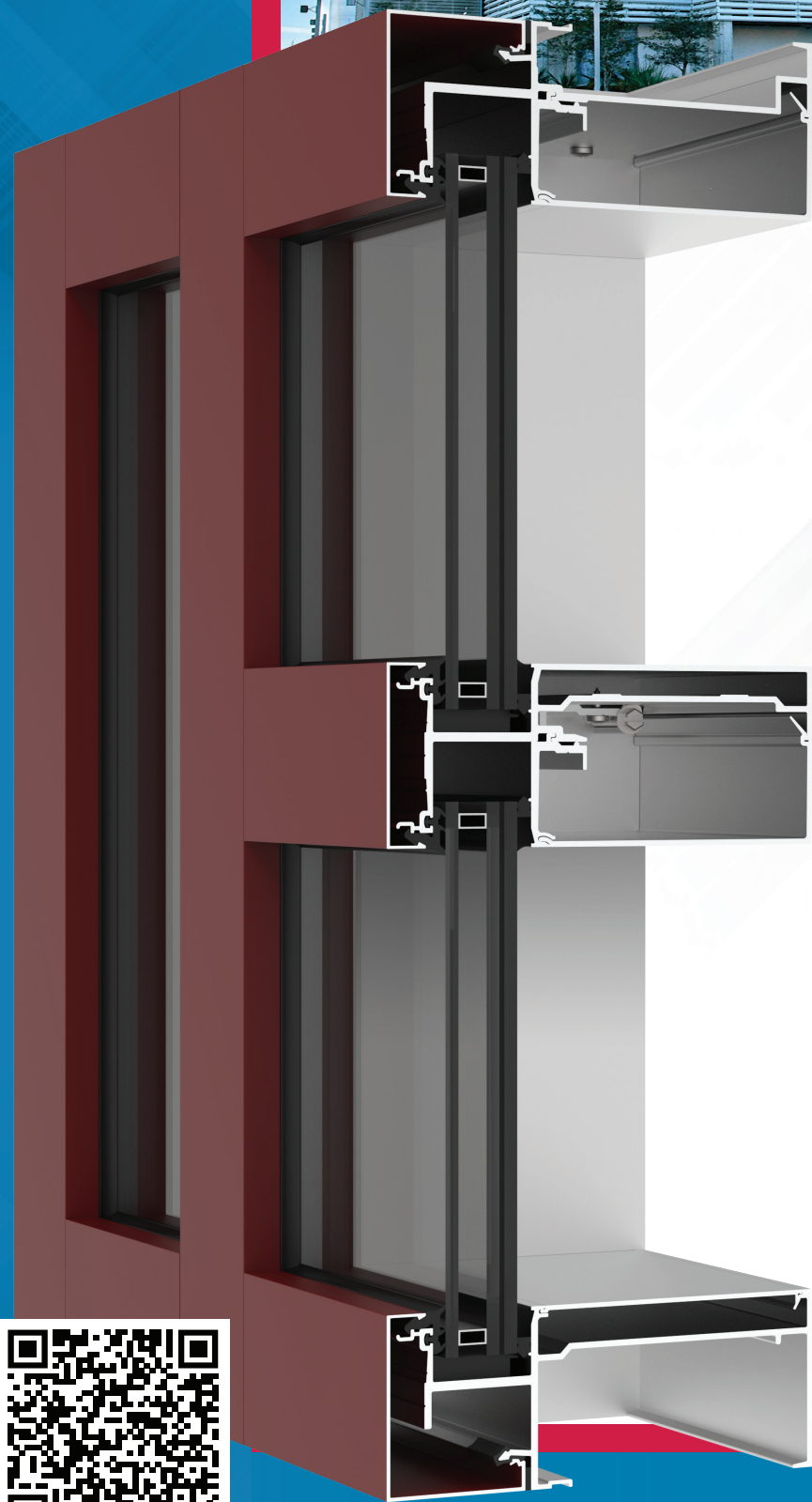

YHC 300 IG SPECS		
Base Depth	7-11/16"	
Sightline	3"	
Config	Inside Glazed / Front Set	
Tested Glass	9/16" Monolithic or 1-5/16" IGU with Low-E (C.O.G. U-Factor: 0.29)	
Test	Results	Standards
Air Infiltration	0.06 CFM/FT <sup>2</sup> (1.10 m <sup>3</sup> /h·m <sup>2</sup> ) @ 6.24 PSF (299 Pa)	ASTM E 283
Water Infiltration	<b>Static:</b> 20 PSF (958 Pa) <b>Dynamic:</b> 20 PSF (958 Pa)	ASTM E 331 AAMA 501

Thermal Performance								
Mullion Depth	U-Factor - BTU/hr·ft <sup>2</sup> ·°F						CRF	
3" x 7-11/16" (1-5/16" Laminated IGU)	0.47	0.45	0.44	0.42	0.40	0.39	63	67
<b>Center of Glass</b>	<b>0.30</b>	<b>0.28</b>	<b>0.26</b>	<b>0.24</b>	<b>0.22</b>	<b>0.20</b>	<b>Frame</b>	<b>Glass</b>
AAMA 507							AAMA 1503	

Finish Options	
Type	Standard
Factory Anodized	AAMA 612
Organic Paints	AAMA 2605

Product Approvals	
Large & Small Missile	Wind Zone 3
Hurricane HVHZ	International ICC
Florida FBC	Texas TDI

## Options Span Beyond Reach

With Steel Reinforcing, the YHC 300 IG can utilize a single span or twin span vertical configuration across openings, up to 24'-0" high, which is as long as our stocklengths are made from the commercial plant. See Dade County NOA or Florida Product Approval for max daylight opening. For continuous mullions with either twin spans or unequal spans with uniformly distributed load on multiple anchors, consult YKK AP engineering.

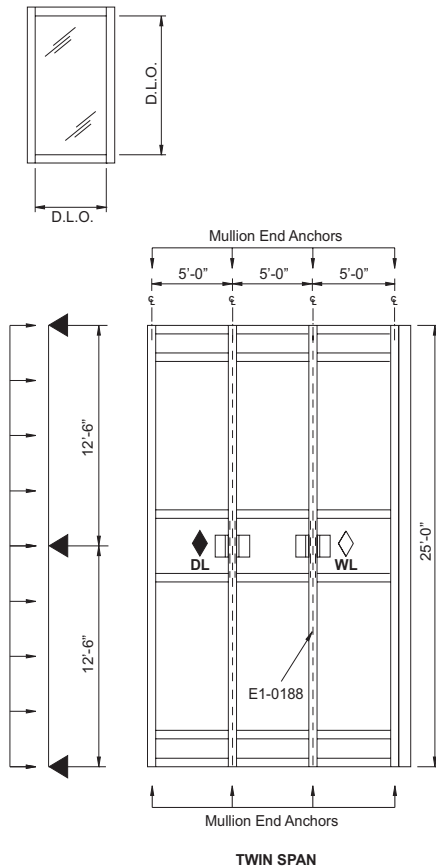

**90psf** has a reinforcement sleeve, E1-3007, attached at midpoint. Reinforcement is anchored with wind load or dead load anchors midway.

**120 & 130 psf** has steel reinforcement, E1-0188, attached to the intermediate verticals. Both mullion and reinforcement are anchored with wind load or dead load anchors midway.

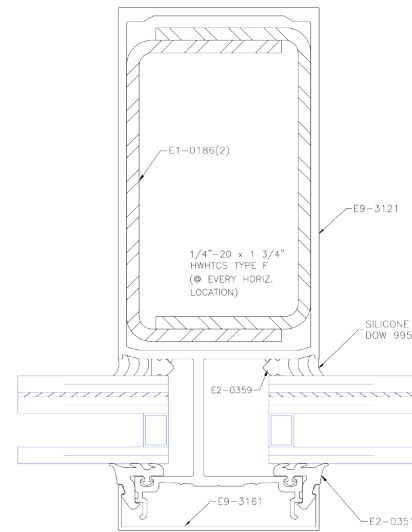

Single Span Vertical Mullion Detail

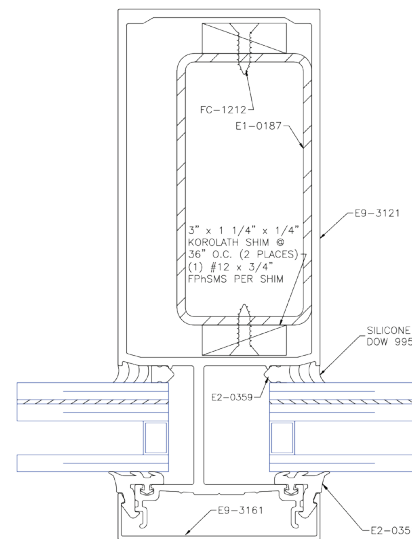

Twin Span Vertical Mullion Detail

Additional information including CAD details, CSI specs, test reports and installation instructions are found on the Product Guide by clicking this link or visiting [www.ykkap.com/commercial/productguide](http://www.ykkap.com/commercial/productguide)