

YKK aP

www.ykkap.com

ProTek
YKK AP Hurricane & Blast Solutions



Florida School for the Deaf & the Blind, Gore Hall - St. Augustine, FL

YHS 50 FI

Impact Resistant and Blast Mitigating Storefront System

The **YHS 50 FI** is a high performance storefront system designed for insulating glass that can be 1" to 1-5/16" thick. With varied infill and components, the YHS 50 can meet the demanding requirements of both Impact Resistance and Blast Mitigation. The system integrates with sun control products, vents and the H or HL series entrances.

- **Hurricane Impact** - Large & Small Missile
- Wind Zone 3 & FPA/Florida HVHZ
- Approved for Missile Level E
- **Blast Mitigation** - Static and Dynamic Analysis capability to meet DoD, GSA and VA standards
- Spans up to 144"; accomodates glass sizes up to 50 square feet
- Single and multi-span applications
- Engineered corners reduce job time
- Design Pressures up to 90 psf

Configuration:

Glazing	Glass Setting	Installation
Outside & Inside	Center Set	Screw Spline

Thermal Values:

U-Factor:	Values as low as 0.43*
CRF:	Minimum 35 frame and 59 glass

*Based on AAMA 507. Lower values may be achieved through further simulation.



YHS 50 FI SPECS		
Base Depth	5"	
Sightline	2-1/2"	
Config	Inside (Dry), Outside (Wet/Dry) / Center Set	
Tested Glass	1-5/16" Laminating IGU with Low-E (C.O.G. U-Factor: 0.29)	
Test	Results	Standards
Air Infiltration	0.06 CFM/FT ² (1.10 m ³ /h·m ²) @ 6.24 PSF (299 Pa)	ASTM E 283
Water Infiltration	Static: 12 PSF (575 Pa)	ASTM E 331
Acoustical (1-5/16" IGU)	Laminated STC: 39 Laminated OITC: 34	ASTM E 90 ASTM E 1425

Thermal Performance								
Mullion Depth	U-Factor - BTU/hr·ft ² ·°F						CRF	
2-1/2" x 5" (1-5/16" Laminated IGU)	0.51	0.49	0.48	0.46	0.44	0.43	35	59
Center of Glass	0.30	0.28	0.26	0.24	0.22	0.20	Frame	Glass
AAMA 507							AAMA 1503	

Finish Options	
Type	Standard
Factory Anodized	AAMA 612
Organic Paints	AAMA 2605

Product Approvals	
Missile Level A, D, E	Wind Zone 3
Hurricane HVHZ	International ICC
Florida FBC	Texas TDI

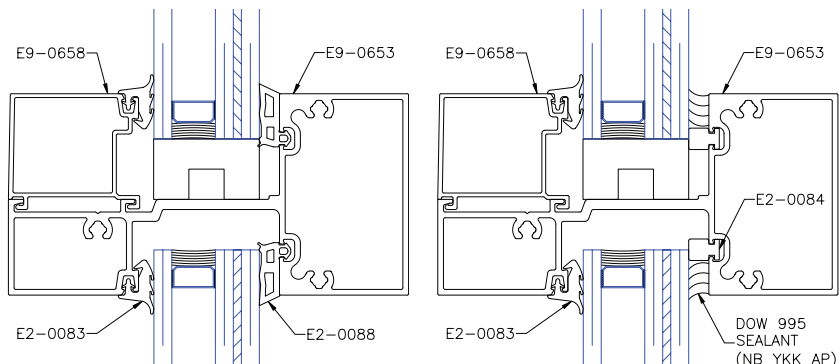

Outside, Dry Glazed

Outside, Wet Glazed

Also, an Inside, Dry Glazed configuration is available

Sill Flashing Design

- ▶ Taller back leg on sill flashing – enhanced water resistance in the field and in water testing
- ▶ Three point attachment of end dam, with a foldable tab and two screws into flashing splines
- ▶ No blind seals eliminates secondary penetration of sill and flashing when properly sealed

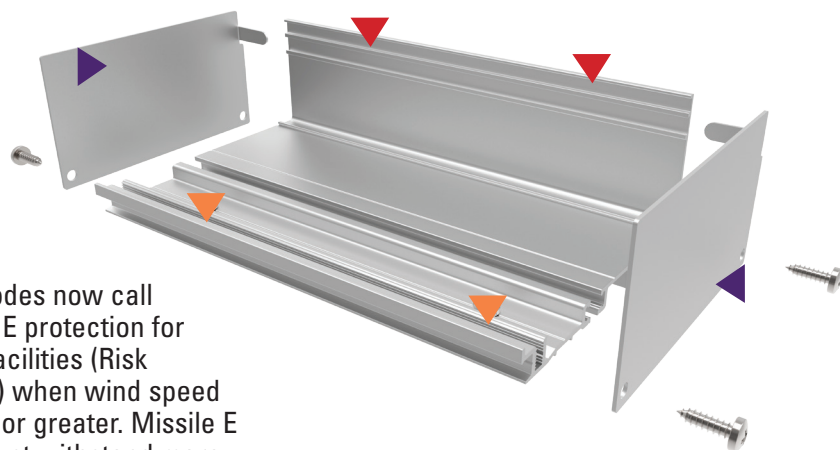

Missile Testing

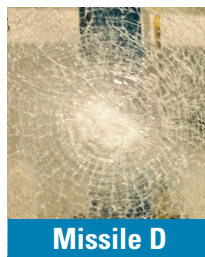

Missile D



Missile E

Building codes now call for Missile E protection for essential facilities (Risk Category 4) when wind speed is 150 mph or greater. Missile E systems must withstand more than twice the impact energy compared to Missile D.

Storefront Impact Comparison

System	.060 SentryGlass 50 PSF	Design Pressure			144" Span	108" to 120" Spans	Impact Testing	
		50 PSF	65-70 PSF	90 PSF			Missile A & D	Risk Category IV Essential Facilities
YHS 50 FS								
YHS 50 FI								
YHS 50 TU								

Additional information including CAD details, CSI specs, test reports and installation instructions are found on the Product Guide by clicking this link or visiting www.ykkap.com/commercial/productguide